

MAGNETIC NORTH
SCALE: 1" = 200'

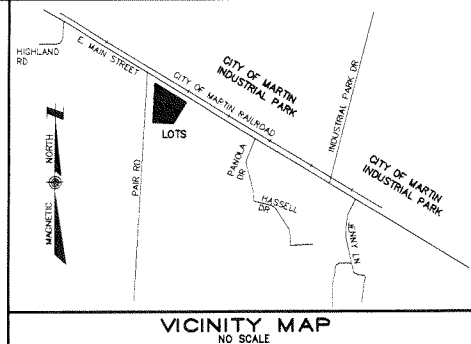

NOTES:

- 1) ALL UTILITIES LOCATED ON THESE LOTS MAY NOT BE SHOWN HEREON. PRIOR TO BUILDING, CONSTRUCTION, ETC. ON THESE LOTS, APPROPRIATE UTILITY AGENCIES SHOULD BE CONTACTED FOR THE LOCATION AND SIZES OF UTILITIES.
- 2) FOR WATER, SEWER, GAS LINES LOCATED ON THESE LOTS, THERE IS A 12" WIDE UTILITY EASEMENT, MEASURED 6' EITHER SIDE OF THE CENTER OF EACH UTILITY.
- 3) A LANDSCAPING AREA/STRIP IS SHOWN ALONG HIGHWAY AND ALONG SOUTH LINE OF LOT 1 AS REQUIRED BY THE CITY OF MARTIN, TN ZONING ORDINANCE. A 5' WIDE STRIP IS REQUIRED ALONG THE HIGHWAY AND A 7' WIDE STRIP IS REQUIRED ALONG THE SOUTH PART OF THE PROPERTY JOINING A RESIDENTIAL ZONE.
- 4) NO TITLE OPINION WAS PROVIDED TO THE UNDERSIGNED SURVEYOR. CROCKER LAND SURVEYING ASSUMES NO LIABILITY FOR MATTERS RELATED TO TITLE.
- 5) SEE FLOOD NOTE FOR REFERENCE TO FLOOD PLAN.
- 6) THE TVA EASEMENT SHOWN HEREON IS APPROXIMATE IN LOCATION. TVA SHOULD BE CONTACTED FOR THEIR EXACT LOCATION OF THE EASEMENT. AT THE TIME OF THE FIELD SURVEY, THERE WERE NO TVA LINES OR POLES EXISTING. TVA SHOULD BE CONTACTED FOR REQUIREMENTS FOR BUILDING IN THE EASEMENT AREA AND FOR WHETHER THE EASEMENT STILL EXISTS.
- 7) LOT 3 IS SHOWN AS LOT 2 OF THE HATCHEL - E. MAIN STREET MINOR SUBDIVISION. LOTS 1 AND 2 ARE SHOWN AS ONE TRACT, BEING LOT 1 OF THE HATCHEL - E. MAIN STREET MINOR SUBDIVISION. THIS LOTS ARE PENDING APPROVAL BY THE CITY OF MARTIN, TN OF THE AFOREMENTIONED MINOR SUBDIVISION WHICH DIVIDES LOT 3 (AS SHOWN HEREON) FROM LARGER PARENT TRACT.

FLOOD NOTE:

THESE LOTS LIE IN THE FOLLOWING ZONES AS SHOWN ON FEMA FIRM MAP 47183C0204D EFFECTIVE DATE: NOVEMBER 5, 2008: PARTLY IN ZONE X (AREAS LYING

FLOOD NOTE:

THESE LOTS LIE IN THE FOLLOWING ZONES AS SHOWN ON FEMA FIRM MAP 47183C0204D EFFECTIVE DATE: NOVEMBER 5, 2008:

ZONE X - AREAS LYING OUTSIDE THE 0.2% ANNUAL CHANCE FLOODPLAIN

ZONE X - AREAS OF 0.2% ANNUAL CHANCE FLOOD; AREAS OF 1% ANNUAL CHANCE FLOOD WITH AVERAGE DEPTHS OF LESS THAN 1 FOOT OR WITH DRAINAGE AREAS LESS THAN 1 SQUARE MILE; AND AREAS PROTECTED BY LEVEES FROM 1% ANNUAL CHANCE FLOOD.

ZONE AE - AREAS IN SPECIAL FLOOD HAZARD AREAS SUBJECT TO INUNDATION BY THE 1% ANNUAL CHANCE FLOOD, BASE FLOOD ELEVATIONS DETERMINED.

SEE THE REFERENCED FLOOD MAP FOR SPECIFIC FLOOD ELEVATIONS AND AREAS. NO FLOOD DETERMINATION OR ELEVATIONS WERE DETERMINED AS PART OF THIS SURVEY.

TOTAL AREA LOTS 1, 2 AND 3:
13.514 ACRES

- LEGEND
- ◊ SET IRON PIN (5/8" STEEL REBAR W/YELLOW PLASTIC CAPS MARKING "CROCKER TN RLS 1125"
 - FOUND IRON PIN
 - △ UNMARKED POINT
 - X- FENCE
 - W- WATER LINE
 - ◊ FIRE HYDRANT
 - S- SANITARY SEWER LINE
 - SANITARY SEWER MANHOLE
 - G- GAS LINE
 - E- AERIAL ELECTRIC/TELEPHONE CABLE LINE
 - ⊥ POWER POLE

In compliance with Rule 0820-03-.06 Maps and Mapping paragraph (5) of Standards of Practice for Land Surveyors in Tennessee, "Electronic survey documents such as CAD files, PDF copies, and word processor documents or other emailed or digitally copies and/or other electronically forwarded information and documents are considered "Preliminary" or "Draft" documents."

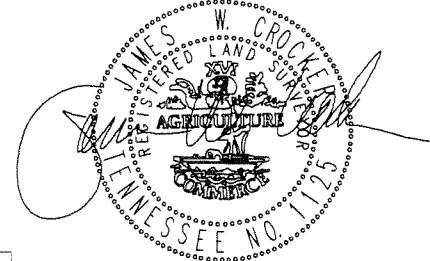

JULY 18, 2012

I, James W. Crocker, hereby certify that this survey was done under my direct supervision and complies with the Standards set by the Tennessee Board of Examiners for Land Surveyors for a Category I Survey, having a ratio of precision of the unadjusted survey greater than 1:10,000.



NOTE:
THIS IS A SKETCH OF LOTS FOR AUCTION BROCHURE ONLY AND IS NOT A FINAL COMPLETE SURVEY OF THE PROPERTY. SEE ORIGINAL PLATS PROVIDED TO THE AUCTIONEER FOR ACTUAL PROPERTY SURVEY AND MINOR SUBDIVISION.

Crocker Land Surveying
397 Herman Brooks Road Martin, Tennessee 38237
731-587-3364 731-642-8749 jimcrocker@frontiernet.net

CURRENT OWNERS:
BILLY J. AND CARRIE L. HATCHEL
865-899 E. MAIN STREET
MARTIN, TN 38237
DIVISION OF PARCEL 4 TAX MAP 79
DEED REFERENCE: BOOK 421 PAGE 138

ZONE: B-2
MIN. BUILDING SETBACKS:
FRONT: 25'
SIDE: 10'
REAR: 15'

SKETCH OF LOTS FOR
BILLY J. AND CARRIE L. HATCHEL
E. MAIN STREET
MARTIN, TENNESSEE
18TH CIVIL DISTRICT WEAKLEY COUNTY
DIVISION OF PARCEL 4 TAX MAP 79
JULY 18, 2012
W79-4A.DWG W79-4AAAA.CRD